

HOLDEN History

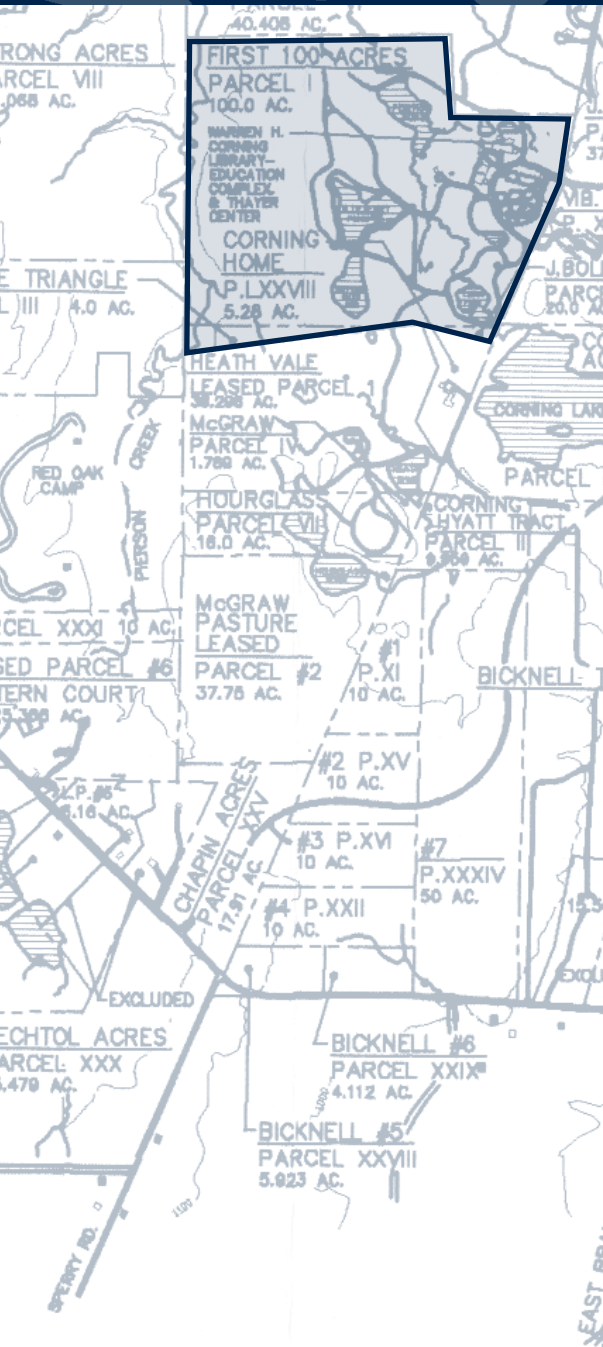

Established in 1931 on a 100-acre parcel donated by Roberta Holden Bole, The Holden Arboretum has grown to 3,500 acres, making it one of the country's largest arboreta.

Holden was created by Albert Fairchild Holden as a memorial for his daughter, Elizabeth, who died in 1908 at the age of 12. The president of the Island Creek Coal Co. and managing director of the American Zinc, Lead, and Smelting Co., Holden was familiar with the Arnold Arboretum at Harvard University and originally intended to leave his estate to that institution. However, his sister, Roberta Holden Bole convinced him that the people of Northeastern Ohio deserved an arboretum. When Holden died in 1913 at the age of 46, funds from his estate were placed in a trust for the development of an arboretum after a life interest for his two teenage daughters, Emery May and Katharine Davis. Originally, the arboretum was to have been located on the family estate in Bratenahl, but family interests precluded its use. An alternate site at the Lake View Cemetery was also considered, but later abandoned.

An extensive survey of the region was conducted before Lake County was chosen as the home for the new arboretum. Roberta Holden Bole again showed her support for the project, donating 100 acres in Lake County, which forms the core of Holden today. During its early years, the Cleveland Museum of Natural History oversaw Holden, creating a firm foundation in the sciences. In 1952, the courts permitted Holden's separation from the museum and its incorporation as a not-for-profit organization.

Nurtured in its early years by the Bole family, Holden also gained the support of investor Warren H. Corning, who built his home Lantern Court on Kirtland-Chardon Road near the fledgling Holden. His support, as well as his success in gaining the support of other area landowners, helped Holden expand to 1,000 acres by 1956. The largest land purchase during that period was the Baldwin farm, a 556-acre parcel that is now home to some of Holden's natural areas, its nut bearing tree collections, and its specimen collection. Corning served as the first unpaid "executive administrator" and would serve in that capacity until 1958.

In 1958, R. Henry Norweb, Jr., Albert Holden's grandson, succeeded Corning. Holden's first paid director, Norweb would lead the organization until his retirement in 1983. Under his direction, land continued to be acquired, facilities and features aimed at attracting and serving the public were added, collections grew and long-term planning began in earnest for the day when the Holden Trust would be available.

Today, Holden is supported by funds from The Holden Trust as well as the contributions of members, donors and business partners.

As Holden celebrates its 75th anniversary in 2006, the organization continues to look toward the future, entering into a new phase of master planning.

The **HOLDEN** Arboretum

Fact Sheet

Founded 1931 on donated land

Original acreage	100
Acreage today	3,500
Elevation	730-1266'
Latitude	41 degrees, 37'30"
Longitude	81 degrees, 17'30"
Average rainfall	43.85"

25 Ponds

	ACRES	LOCATION
Baldwin	0.75	Scout Cabin area
Blueberry	2.20	Display Garden
Buttonbush Bog	1.40	Display Garden
Carver's	9.30	North of Wisner spring
Crystal	0.16	Butterfly Garden
Fisherman's (6 ponds)	9.15	Kirtland-Chardon Rd
Fosters	2.10	Display Garden
Heath East	1.02	Rhododendron Garden
Heath West	1.80	Rhododendron Garden
Hourglass	3.10	Rhododendron Garden
HSC	0.83	Horticultural Science Ctr.
John Bole	0.43	Bole House
Lily	0.30	Lantern Court Gardens
Lotus	0.80	Display Garden
Oak	0.23	Rhododendron Garden
Reflecting	0.18	Butterfly Garden
Sassafras	0.18	Overflow Parking
Strong Acres	0.27	Strong Acres Area
Turtle	0.92	Lantern Court Gardens

1 Lake

	ACRES	LOCATION
Corning Lake	15.2	Display Garden

Hiking Trails

More than 20 miles of trails, including:

	MILES
Blueberry Pond	0.5
Bole Woods	1.5
Corning Lake	1.0
Crabapple	0.5
Highlights	1.0
Highlights extension	2.0
Old Valley	2.8
Pierson Creek Loop	1.9
Sensory	0.5
Woodland	1.5

Plants

19,230 accessioned plants and mass plantings:

- 14,711 woody — 4,519 herbaceous
- 6,026 taxa (types of plants)
of which 1,324 were collected wild
- 147 families
- 688 genera
- 2,199 species
- 3,273 cultivars
- 2,212 hybrids

Collections

Conifer	Magnolia
Crabapple	Nut Tree
Arthur S. Holden Sr. Hedge	Specimen Tree
Lilac	Viburnum

Gardens

	ACRES	PLANTS
Arlene and Arthur S. Holden Jr. Butterfly Garden	2	1,048
Myrtle S. Holden Wildflower Garden (29 habitats)	5	1,788
Helen S. Layer Rhododendron Garden	20	2,123
Ann M. Whitney Memorial Garden		57
Display	30	2,192
Lantern Court	25	

Holden Natural Areas

	ACRES
Baldwin Natural Areas	530
Bole Woods	92
Brainard Bog	15
Carver's Pond	9
Corning Woods	125
East Branch of the Chagrin	6
Fisherman's Pond Area	210
Holden Meadows	350
Little Mountain	190 acres/ 1,266' peak elevation
Pierson Creek Valley	570
Stebbins Gulch (N and S)	820
Strong Acres	310
Bicknell Sugarbush	30